

Mercedes wei whether electricity installation instructions



1. Remove the original rear door trim



2. Remove the original car right bracket and brace, we lower bracket installation, pay attention to the stent placement, ball head itself, in our screws, the screws with the original car. Note: to be one of the door



3. Remove the original car right bracket and brace, our upper bracket installation, pay attention to the stent placement, ball head, with our screws

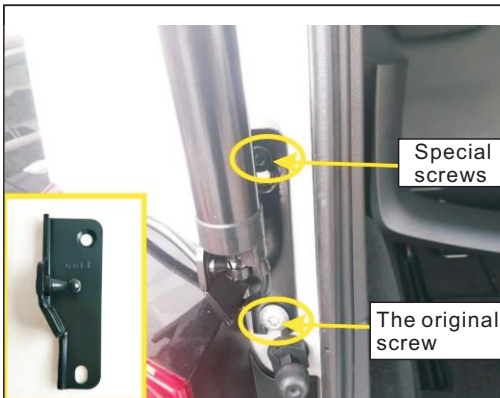

4. Remove the original car bottom bracket and brace, we lower left bracket installation, pay attention to the stent placement, ball head itself, in our screws, screws with the original car below. Note: to be one of the door



5. Remove the original car left bracket and brace, we left bracket installation, pay attention to the stent placement, ball head, with our screws



6. The two screws removed within the yellow circle, remove the lights (or steps)

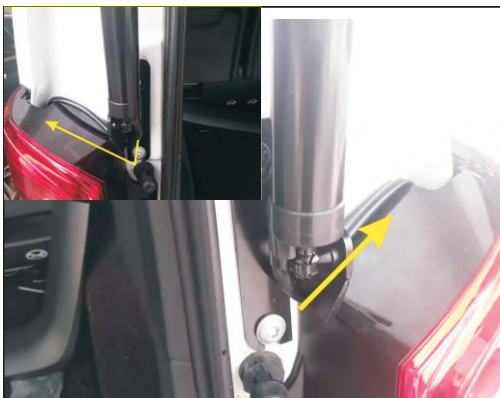

7. Poles line from the lamp go line, restore lights (or steps)



8. Remove the plaque punch, main driving installation before we switch button

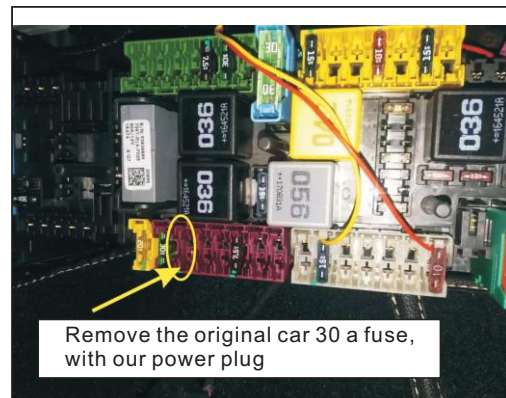

Remove the original car 30 a fuse, with our power plug

9. Below the co-pilot remove the plaque, found the power and unplug the original car 30 a fuse, plug in our power plug

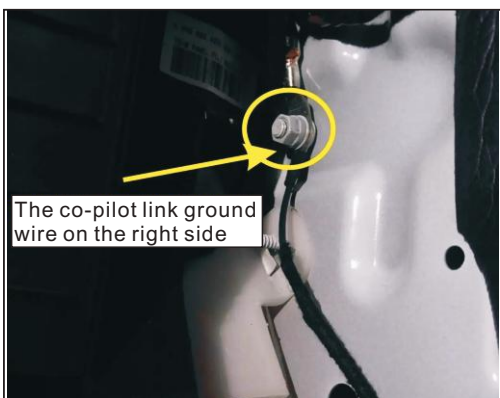

The co-pilot link ground wire on the right side

10. Found in the co-pilot on the right side of ground wire, connect the ground wire



11. Main driving removed this seat belt B column, 'll take out the screws and remove the seat

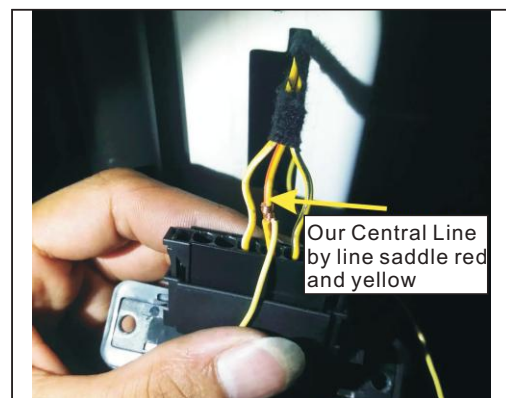

Our Central Line by line saddle red and yellow

12. Our Central Line to meet the saddle the red line (from left to right in the first row third hole)

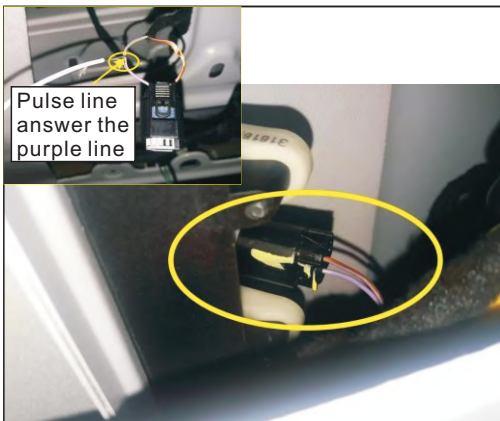

Pulse line
answer the
purple line

13. Remove the tail gate pulse line socket (socket of the original car trunk), pulse line meet the saddle purple line

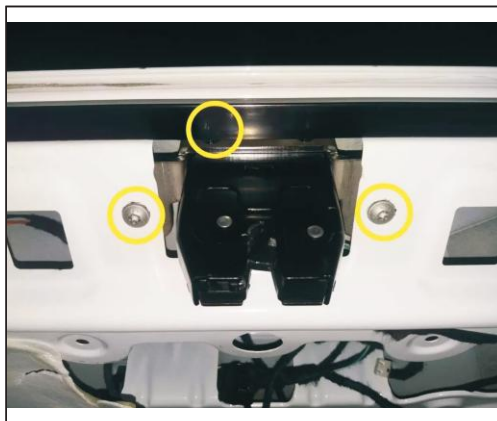

14. Yellow circle 3 screws removed, remove the original car door lock, installed on our electric lock, use the original car screws

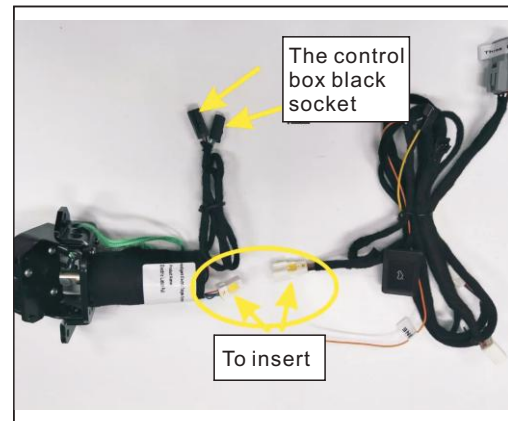

The control
box black
socket

To insert

15. Plug as shown in our company electric socket



16. Remove the plaque, find the original lock buckle



In the original lock
button below to add
a gasket

17. Remove the original lock buckle, in the original lock button below to add a gasket



18. Sucked and poles, electric outlet a pair of control box, installation position and control box, use the original car fixed screws, springs and washers

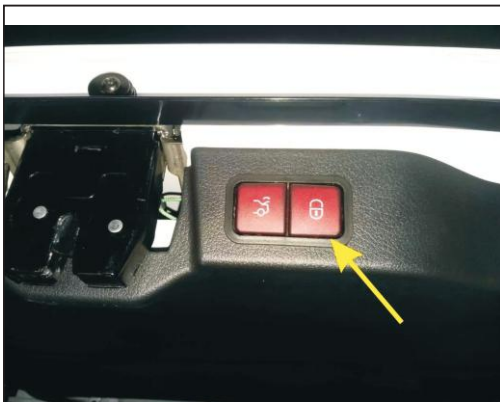

19. At the rear door trim with a blade cut a small square, install our stern door keys